

LX3 Router Lift Owner's Manual



LAGUNA

Laguna Tools
744 Refuge Way, Suite 200
Grand Prairie, TX 75050
lagunatools.com

LX3 Router Lift Owner's Manual

Scope of This Manual

This manual outlines the basic procedures for the LX3 Router Lift.

For detailed instructions and videos, please go to www.lagunatools.com. Refer to www.lagunatools.com for the latest manual revision.

Customer Service

For technical support, please contact Laguna Tools Customer Service by phone 1-800-332-4094. Please note the router lift type in the subject line.

In the space provided, record the serial number, model number, and install date of the router lift.

Serial Number:	
Model Number:	
Install Date:	



Copyright © 2025

Laguna Tools, Inc.

ALL RIGHTS RESERVED

This document contains material protected under International and Federal Copyright Laws and Treaties. Any unauthorized reprint or use of this material is prohibited. No part of this document may be reproduced or transmitted in any form or by any means, electronic or mechanical, including photocopying, recording, or by any information storage and retrieval system without express written permission from the author/publisher. LAGUNA® and the LAGUNA Logo® are the registered trademarks of Laguna Tools, Inc.

DISCLAIMER

Laguna Tools is not responsible for errors or omissions. Specifications subject to change. Router lifts may be shown with optional accessories.

Revision 01 (10/03/2025)

Table of Contents

1.0	General Information and Safety	6
1.1	Overview	6
1.2	Safety Signs and Callouts	6
1.3	Proposition 65 Warning of Harmful Exposure	7
1.4	Intended Use	7
1.5	Safety Information.....	7
1.6	Router Lift Safety Information.....	12
2.0	Definitions	13
3.0	Specifications	14
4.0	LX3 Router Lift Overview	15
4.1	Features.....	15
5.0	Setup and Assembly	17
5.1	Router Lift Placement	17
5.2	Packaging Contents.....	18
5.3	Installing the Router Lift.....	19
5.4	Installing the Router (router not provided).....	22
5.5	Installing the Router and Router Lift Table	24
5.6	Scale Plate.....	24
5.7	Starter Pin.....	25
6.0	Replacing the Belt	27
7.0	Maintenance	28
8.0	Troubleshooting	29

LX3 Router Lift Owner's Manual

9.0	Exploded Parts View and Parts List	31
10.0	Warranties.....	35

1.0 General Information and Safety

1.1 Overview

SAVE THIS MANUAL. Keep this manual for the safety warnings, precautions, assembly, operating, inspection, and maintenance procedures. Read this Owner's Manual in its entirety prior to assembly or operation. Refer to www.lagunatools.com for the latest manual revision.

Read and understand all warnings and operation instructions before using any tool or equipment. Always follow basic safety precautions to reduce the risk of personal injury. Improper operation, maintenance, or modification of tools or equipment could result in serious injury or property damage. Laguna Tools equipment is designed for specific and limited applications. This product should not be modified nor used for any application other than its intended use.

PERSONAL SAFETY IS THE RESPONSIBILITY OF THE OPERATOR.

1.2 Safety Signs and Callouts

Safety signs and callouts draw attention to potential hazards during router lift operation. This Owner's Manual uses the following callouts to indicate the importance of each safety message.

 **DANGER**

An imminently hazardous situation which, if not avoided, will result in death or serious injury.

 **WARNING**

A potentially hazardous situation which, if not avoided, could result in death or serious injury.

 **CAUTION**

A potentially hazardous situation which, if not avoided, may result in minor or moderate injury.

 **NOTE**

A helpful tip from Laguna Tools technical staff.

1.3 Proposition 65 Warning of Harmful Exposure

Some dust created by sanding, sawing, grinding, drilling, machining, and other construction activities contains chemicals known to the state of California to cause cancer, birth defects, or other reproductive harm. Some examples of these chemicals are:

- Lead from lead-based paint.
- Crystalline silica from bricks, cement, and other masonry products.
- Arsenic and chromium from chemically treated lumber.



Fire Warning

Use extreme caution when working with flammable materials such as wood or acrylic, as they are more volatile than other materials.

Keep the router lift clean and follow the maintenance schedule.

Always have a fire extinguisher ready to extinguish a fire.

Never leave the router lift running unattended.

The tools sold by Laguna Tools are safe when used properly, as described by the American National Safety Institute, the UL Standards of safe tool use, and the IEC standards of safe tool use. Laguna Tools is in no way responsible for injury or death that occurs while using this product.

The risk of exposure varies depending on frequency of use. To reduce exposure to these chemicals, work in a well-ventilated area and work with approved safety equipment, such as face or dust masks that are specifically designed to filter out microscopic particles. For more information go to <https://www.p65warnings.ca.gov/>.

1.4 Intended Use

The router lift is designed to make adjusting the height of a router bit on a router table easier and more precise. Do not use this router lift for anything other than its intended use.

1.5 Safety Information

Read and understand the entire owner's manual before attempting assembly or operation. Read and understand the warnings posted on the router lift and in this manual. Failure to comply with all warnings may cause serious personal injury or damage to the router lift.

LX3 Router Lift Owner's Manual

The router lift is designed and intended for use by properly trained and experienced personnel only. Personnel who are not familiar with the correct and safe operation of the router lift should not operate the router lift until properly trained.

1. Never operate the router lift under the influence of drugs or alcohol, when tired, or when distracted.
2. Stay alert at all times while operating the router lift.
3. Always wear safety glasses and hearing protection.
4. Do not wear clothing, apparel, or jewelry that can become entangled in moving parts. Always tie back or cover long hair. Wear non-slip footwear to reduce the risk of slipping and losing control or accidentally contacting cutting tool or moving parts.
5. Never stand on the router lift. Serious injury may occur if the router lift is tipped or if the cutting tool is unintentionally contacted.
6. Know where the emergency stop switch is located.
7. Perform daily inspection of the router lift for damaged, loose, or improperly adjusted parts or any condition that could affect safe operation. For your own safety, do not operate the router lift with damaged parts.
8. Use the router lift only in clean areas free from excessive moisture or flammable objects.
9. Keep the working area clean and ensure adequate lighting is available.
10. Cables and cords should be inspected regularly.
11. Do not attempt to exceed the limits of the router lift.
12. Keep the router lift, electrical cabinet, and cables away from excessive heat, flammable substances, and sharp objects.
13. Keep the router lift, electrical cabinet, and surrounding area clear of obstructions and free from excessive moisture.
14. Safety Signs should be attached to places that are easy to spot.
15. Disconnect power to all system components when not in use, when changing accessories, and before servicing. Remove the switch keys or lock-out the router lift to prevent unauthorized use and child-proof the workshop.
16. Exercise care with router lift controls and around keypad to avoid unintentional start-up.
17. The router lift must be level. Level the router lift if the ground is uneven.
18. Ensure all the nuts and bolts are secured.

LX3 Router Lift Owner's Manual

19. Keep cutting tools clean and sharp.
20. Do not use dull, gummy, or cracked cutting tools.
21. Lubricate and change accessories when necessary.
22. Keep the lift clean and dry.
23. Consult the Owner's Manual or contact Laguna Tools for recommended accessories. Using improper accessories will increase the risk of serious injury or damage.
24. Keep a copy of this manual for future reference.

1.5.1 Shop Environment

1. Verify that the router table can support the router lift and workpieces.
2. Ensure the floor around the router lift is clean and free of scrap material, oil, and grease.
3. Keep the router lift away from overhead pipes, plumbing fixtures, sinks, faucets, and other water sources to prevent rusting and corrosion of the components of the router lift.
4. Provide adequate room between this router lift and other router lifts in the shop to reduce the chance of accidental jarring when transporting lumber or other heavy materials through the shop and while materials are being worked on other router lifts.
5. Ensure that the lighting your router lift is placed under is sufficient to safely perform regular operation and maintenance. Any glares, shadows, or strobe lighting which may distract or prevent the operator from safely operating the router lift should be removed from the working area.
6. Store cutting tools in a dry location and prevent contact to preserve the cutting edge.

1.5.2 Health and Safety

1. Always wear approved personal health and safety equipment as indicated for the materials and type of operations that will be performed. These should include face, eye, respiratory, hearing, and body safety protection devices. Wear safety glasses/face shield and ear protectors (plugs or muffs) even during short periods of operation.
2. Before operating this router lift: remove all hand, wrist, or neck jewelry and push sleeves up over the elbows. Do not wear loose clothing which may become caught in the router lift and confine long hair. Non-slip footwear or anti-skid floor strips are recommended.
3. Use a dust mask or other safeguards to avoid inhaling dust generated from wood products.
4. Install dust collection equipment consistent with shop ventilation practices and budget.

LX3 Router Lift Owner's Manual

5. Remove dust and debris from the floor frequently to prevent slipping. Drilling, sawing, sanding, or machining wood products generates wood dust and other substances known to the State of California to cause cancer. Wood products also emit chemicals known to the State of California to cause birth defects or other reproductive harm (California Health and Safety Code Section 56).
6. In addition to other health hazards, dust from wood and other materials is flammable. Do not operate welding, wood burning, smelting, soldering, or other high-heat tools on the router lift or vicinity.
7. Do not operate this router lift while tired or under the influence of drugs, alcohol, or any medications.

1.5.3 Additional Safeguards

1. Install safety guards consistent with general shop safety practices. Always keep safety guards in place when the router lift is in use. If removed for maintenance purposes, use extreme caution, and replace the guards immediately after completion of maintenance.
2. Check damaged parts immediately. Before further use of the router lift, a guard or other part that is damaged should be carefully checked to determine that it will operate properly and perform its intended function.
3. Keep visitors a safe distance from the work area. Keep children away.
4. Control liquids in the shop to limit the possibility of spillage that can damage the router lift and potentially cause damage or personal injury from electric shock or fire

1.5.4 Maintenance

1. Disconnect the router or other electrical components from power when performing any maintenance.
2. Establish a weekly and monthly maintenance checklist and follow it diligently.
3. Routine maintenance should include periodic checks for alignment of moving parts, looseness, or binding of moving parts, worn or bare wires, breakage of parts, skewed mounting, and any other conditions that may affect its operation or cause injury. Analyze breakage or damage to determine the cause and take appropriate remedial action.
4. Do not operate the router lift if a component is damaged. It should be properly repaired or replaced before use.
5. Store maintenance tools and supplies nearby, consistent with the shop maintenance practices and resources.

LX3 Router Lift Owner's Manual

1.5.5 Operational Practice

1. Never leave the router unattended. Always be in close reach in case of emergency
2. Turn off the power and do not leave the router until it comes to a complete stop.
3. Avoid pinch points and entanglement hazards. Keep hands and clothing away from any moving objects, rotating/moving cutting tools, ball screws, bearings, gantries, guide rails, and any other hazards while in operation.
4. Use the right tool at the correct speed and feed rate. Do not force a tool or attachment to do a job for which it was designed. The right tool will do the job better and more safely.
5. Do not touch a cutting tool immediately after use. It will be hot and may cause skin burns. Exercise caution when handling any cutting tool and accessories. If the cutting tool is hot, keep a heat-resistant glove or oven mitt on hand for this purpose.
6. Do not lay a hot cutting tool on its side.
7. Use recommended accessories; improper accessories may be hazardous.
8. Do not use dull, gummy, or damaged cutting tools such as blades, bits, etc. Keep cutting tools clean and sharp for the best and safest performance.
9. Turn off the router before cleaning. Use a vacuum, brush, or compressed air to remove chips or debris. Do not use bare hands.
10. Do not climb or stand on the router lift. Serious personal injury and costly damage could occur if the router lift tips over or any component is dislodged.
11. Remove loose items and unnecessary workpieces from the table before starting the router lift.
12. Plan tool paths to make multiple passes rather than to take off a large amount of material at one time. This will reduce mechanical stress and heat on cutting tools.
13. Inspect the material of the workpiece to detect any defects that may result in ejection of large pieces of scrap.
14. Verify the workpiece is free from nails, hardware, or other foreign objects.
15. After installing a cutting tool, verify the collet is securely tightened. An unsecured cutting tool may fly loose from the collet and cause injury. Verify that the adjusting wrenches have been removed and are secured before turning on the power.

1.6 Router Lift Safety Information

A router is a dangerous tool and there are hazards inherent with using your router. Some of these hazards are discussed below. Use common sense when operating your router and the router lift and use them only as instructed. Make sure to follow the safety rules and guidelines that are outlined in the manual of your specific router.

Read and understand the instruction manual and all safety warnings before operating your router lift. Failure to comply with these warnings may result in serious personal injury. Save these instructions and refer to them whenever necessary.

5. For your own safety, read instruction manual before operating shaper.
6. Do not expose the router lift to rain or use in damp locations.
7. Do not operate the router lift without all guards and covers properly installed.
8. Do not use awkward hand positions.
12. Keep hands away from router bits and use fixture when necessary. Never reach around or over the router. Use feather boards starter pin and/or push sticks to keep your hands away from the router bit. Keep proper footing and balance at all times.
13. Always run your workpiece against the rotation direction of the router bit. Never cut pieces between the fence and the router bit.
14. Always ensure the router bit is in good working condition before use. Examine the router bit prior to use and replace the bit if it is damaged.
15. Ensure the router lift and your router are installed securely before use.
16. Maintain the router lift as specified in this manual. Use only identical replacement parts when servicing the router lift.
18. Check to make sure the router lift is in working order before use. For example, check the alignment of moving parts, look to see whether moving parts are binding or rubbing, check to see whether parts are broken, make sure accessories are properly installed, and check any other conditions that may affect the operation of the router lift. Any parts that are damaged should be properly repaired or replaced.

2.0 Definitions

Router-table mounting plate – This is the flat surface that the router lift attaches to, and it's typically designed to fit into a router table.

Carriage – The carriage is the mechanism that holds the router and allows it to be raised and lowered within the lift.

Insert rings – These are rings of different sizes that fit into the router table insert plate, allowing you to match the opening to the size of the router bit you're using.

Crank handle – A handwheel used to manually raise or lower the router bit and to tighten the router clamps to secure the router into the router lift

Fine-adjustment screw – Used to make precise adjustments to the router bit height after using the quick-adjust mechanism.

Collet – A clamping device that holds the router bit securely in the spindle.

Above-the-plate bit changes – The ability to change router bits from above the router table, which is a major advantage of using a router lift.

Direct-drive system – A type of lift mechanism that minimizes moving parts and potential wear.

Snugger bars – Adjustable bars used to ensure a tight fit of the router lift in the router table opening.

Leadscrew – A threaded rod used in some router lifts for height adjustment.

Starter Pin – Also called a start pin, or guide pin, the starter pin is an essential safety feature that is used to start a cut when routing on the lift when not using a router fence."

3.0 Specifications

LX3 Router Lift Specification Table	
Router Plate (L x W x H) {inches}	11.75" x 9.25" x 3/8"
Lift post diameter (inches)	3/4" Acme-threaded post.
Insert Ring Size	2 3/4"
Minimum Router Diameter (inches)	3"
Maximum Router Diameter (inches)	4.3"

4.0 LX3 Router Lift Overview

The LX3 Router Lift delivers precision with four heavy-duty $\frac{3}{4}$ " Acme-threaded posts synchronized by a maintenance-free timing belt. Its 4.3" opening with a 3-arm adjustable clamp fits routers from 3" to 4.3" without inserts or repositioning. Magnetic insert rings allow fast, tool-free changes, while the $\frac{3}{8}$ " thick, clean top plate ensures smooth material flow. Adjustable leveling pads and edge tension guides provide a secure, vibration-free fit that's easy to service.

4.1 Features

- $\frac{3}{4}$ " diameter Acme threaded posts
- Maximum of 4.4" router opening
- $\frac{3}{8}$ " thick top plate
- Adjustable edge tension guides



1. **Starter Pin Holes** – The included starter pin can be inserted into either of the tapped holes to provide a control point when routing without a fence.
2. **Insert Ring** – Used for router bits of different sizes and allows users to select the correct insert plate to match the bit and type of cut that they are doing.
3. **Insert Ring Release Button** – Releases the center insert ring for removal
4. **Scale Plate** – Increment wheel with center socket for elevation handwheel. Each full revolution of the handwheel raises or lowers the lift exactly $\frac{1}{16}$ " of an inch. Each individual increment is $\frac{1}{512}$ " (0.001953125").
5. **Limit Stop** – Limits the downward travel of the lift and is positioned at the bottom of the lift post with the control gears.
6. **Drive Belt** – This belt is responsible for driving the gears to raise/lower the lift.
7. **Lift Post** – 4 Acme threaded posts are located at the outside corners for maximum support and precise movements of the lift.

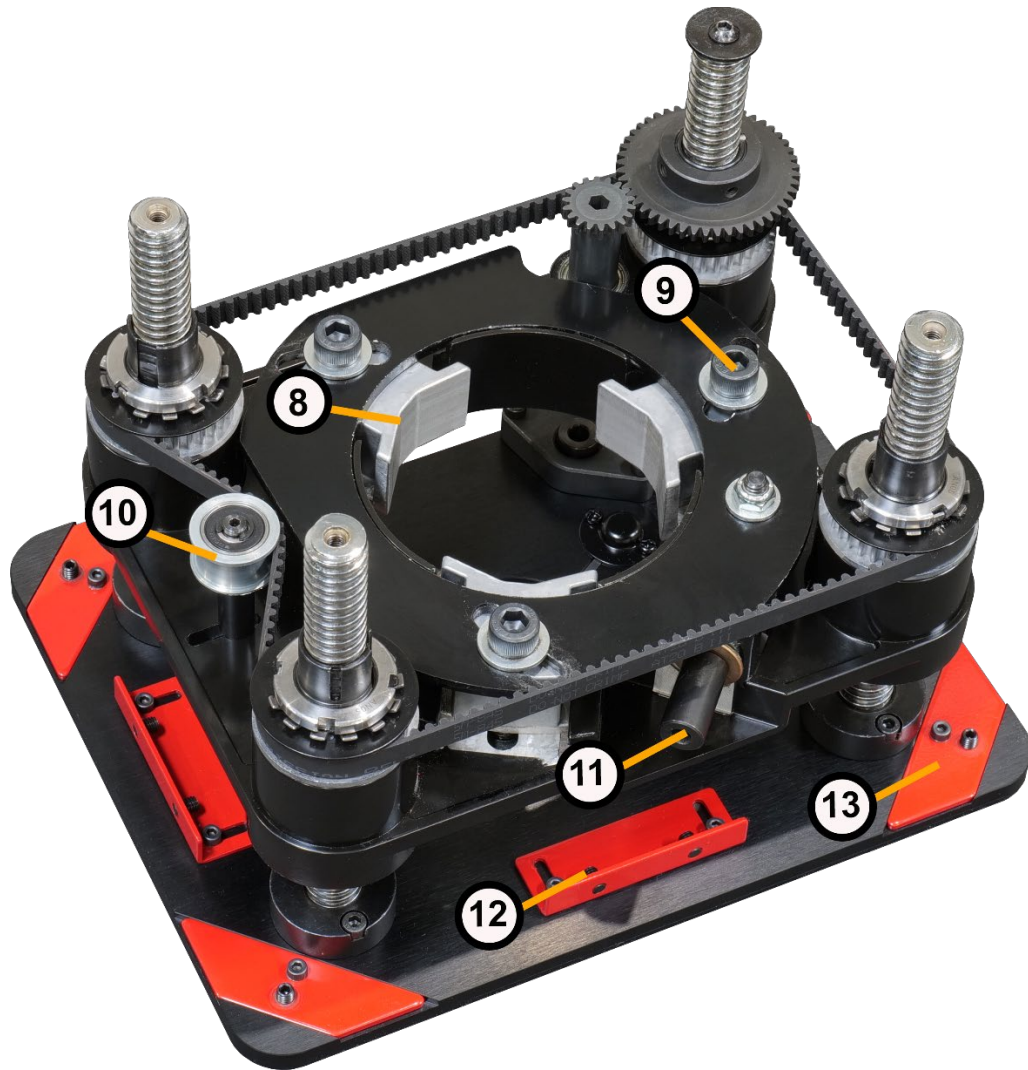

8. **Slide Block** – Three adjustable clamping jaws to securely hold routers from 3" to 4.3" diameter.
9. **Lock Bolts** – Three lock bolts secure the clamping jaws in place after clamping the router.
10. **Idler** – The adjustable idler bearing maintains proper belt tension. It can be adjusted to increase or decrease the belt tension as needed.
11. **Adjusting Screw** – Adjusts the clamping jaws in and out using the handwheel in the adjusting screw to tighten and loosen the jaws.
12. **Gap Adjuster Plates** – These plates can be adjusted to tighten the fit of the router lift in the table opening.
13. **Leveling Plates** – The 4 corner leveling plates provide a larger surface area for leveling the router plate than small screws. Dual screws adjust and lock the leveling plates in place once adjusted.

5.0 Setup and Assembly

Please carefully read and understand all setup and assembly instructions before beginning this procedure.



DO NOT plug in the router until setup and assembly is complete.





5.1 Router Lift Placement

When unpacking the router lift separate all enclosed items from the packing materials and inspect each for damage. Save the packaging materials until all issues concerning missing or damaged items have been resolved.

Select the area where the router lift will be operated. The physical environment where the router lift is located is important to safe assembly and operation. Before removing the router lift from its packaging, consider the weight load, lighting, dust collection, and space allocation available for the lift and accompanying materials. Guidelines for properly placing the router lift follow:

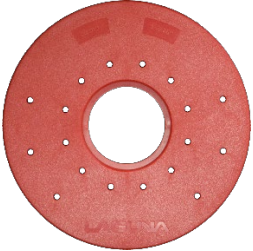
1. There should be sufficient area around the router lift to facilitate easy access to the workpiece, perform maintenance, and provide a safe exit path in the event of an emergency.
2. Install router lift into a suitable table opening in a stand-alone router table, or in a suitable table extension.
4. Allow an area for the storage of workpiece materials, finished products, and tools.
5. Leave ample space around the router lift for the operator to handle both the equipment and the materials being cut.
6. Leave enough space around the router lift to perform maintenance as required in the Owner's Manual.

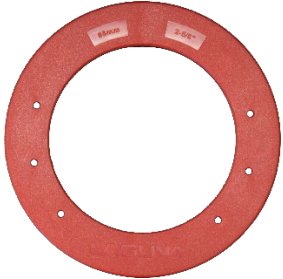
5.2 Packaging Contents

- A  1x- Router lift
- B  1x- 1 3/16" router ring
- C  1x- 1" router ring
- D  1x- 2 5/8" router ring
- E  1x- 10mm Allen key

LX3 Router Lift Owner's Manual

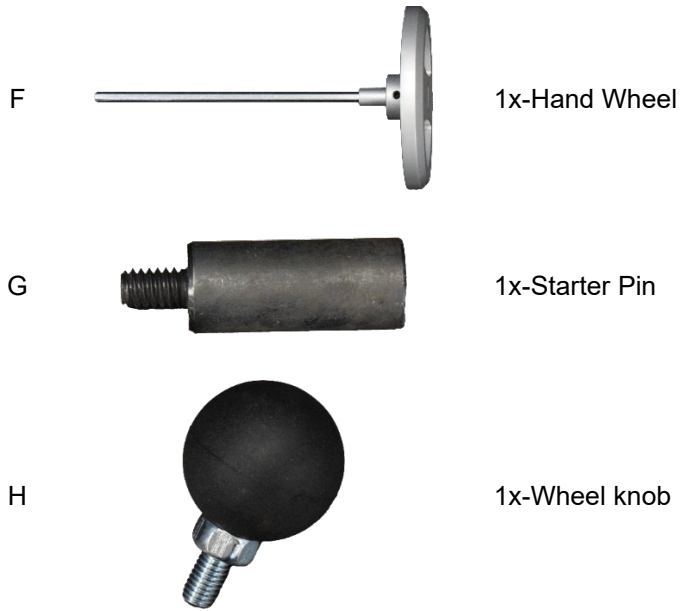

Remove all contents from the shipping boxes. Do not discard the carton or packing materials until the assembly is complete. Accessories commonly ship inside the router lift or stand packaging and can be easily overlooked. If you cannot find an item listed in the packaging contents, check the mounting locations or examine the packaging materials very carefully. Certain components may have been pre-installed for shipping purposes. There may be extra packing contents or hardware that is included.

5.3 Installing the Router Lift

1. Thread the wheel knob onto the handwheel and tighten.



LX3 Router Lift Owner's Manual

2. Ensure that a table opening measuring 9.25" x 11.75" with $\frac{3}{4}$ " radius corners is made. The ledge that the router lift will rest on should be slightly more than $\frac{3}{8}$ ". This ensures that the corner leveling plates can be used to level the lift to the table. Below is a dimensional drawing of the measurements for the table opening.

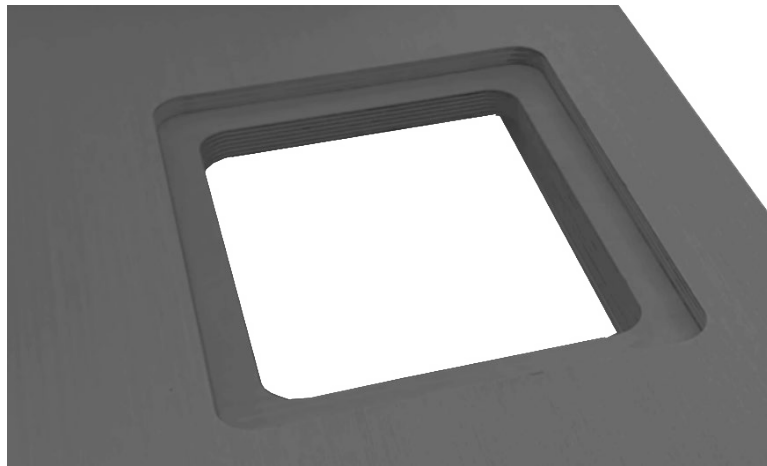
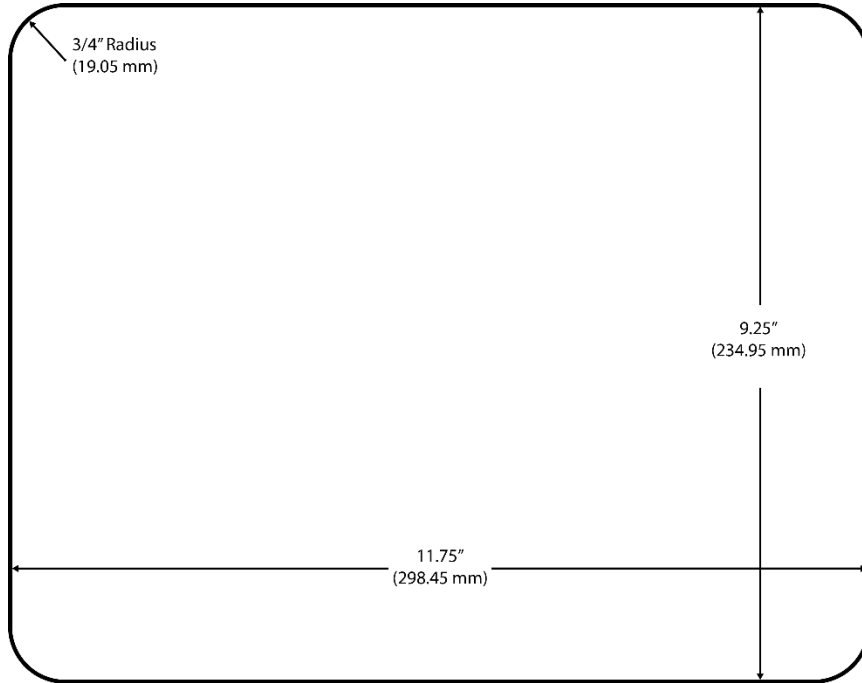

3. Insert the router lift into the table opening and level the top surface of the plate to the top surface of the table using the 4 corner leveling pads. Once the insert is level, lock the leveling plates in place using the 2nd screw in the plate.
4. Adjust the gap adjuster plates on the short end and long side of the router so that there is no movement side to side or front and back of the router plate in the table opening. The fit should be positive so that there is no movement, but not so snug that router lift is hard to remove from the table.

LX3 Router Lift Owner's Manual

5. Install an insert ring into the table opening, aligning the magnets to retain the insert ring. Check to make sure that the insert ring is flush with the table surface by using a straight edge.
6. Adjust the leveling and elevation of the insert ring if needed using the three Allen screws from the bottom side of the router lift plate adjacent to the center opening. Use a 3mm Allen Key to adjust the screws.
7. Insert the elevation handwheel into the scale plate. Ensure that the handle is fully inserted so that it engages the gear mechanism in the lift body section of the lift.
8. Turn the handwheel clockwise to raise the router lift mechanism to its maximum elevation, then remove the handwheel.



5.4 Installing the Router (router not provided)

WARNING

Unplug your router before installing or removing it from the router lift.

1. Remove the router lift from the opening and set it upside down on the table.
2. Use the supplied 8mm Allen key to loosen the three clamping bolts on the bottom side of the three clamp positions. Do not remove the bolts all the way.
3. Insert the hex shaft of the handwheel into the adjustment dial socket on the side of the router lift.
4. Rotate clockwise to retract the clamps to the fully open position.

NOTE

If your router has locating pins on the outside of the motor body, align these pins so that they fall between the clamping pads in the router lift.

If your router has a rack gear mounted to the motor body (Porter-Cable 890), you must first remove the rack gear before inserting the router into the router lift,

or align the gear between the clamping pads in the router lift.

5. With the router unplugged, insert the router through the router lift all the way down, stopping just before the motor contacts the nuts and bolts around the opening.

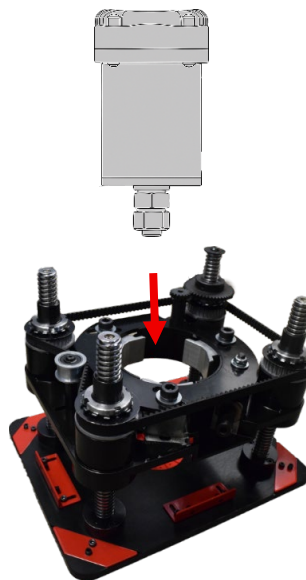

LX3 Router Lift Owner's Manual

6. Tighten the router motor into the lift using the Allen key on the handwheel or other 1/4" Allen key. Ensure that the router is tightened firmly to avoid movement of the router during operation. This should be checked periodically. Turning the dial clockwise shortens the length of the clamps, counterclockwise extends the length of the clamps.

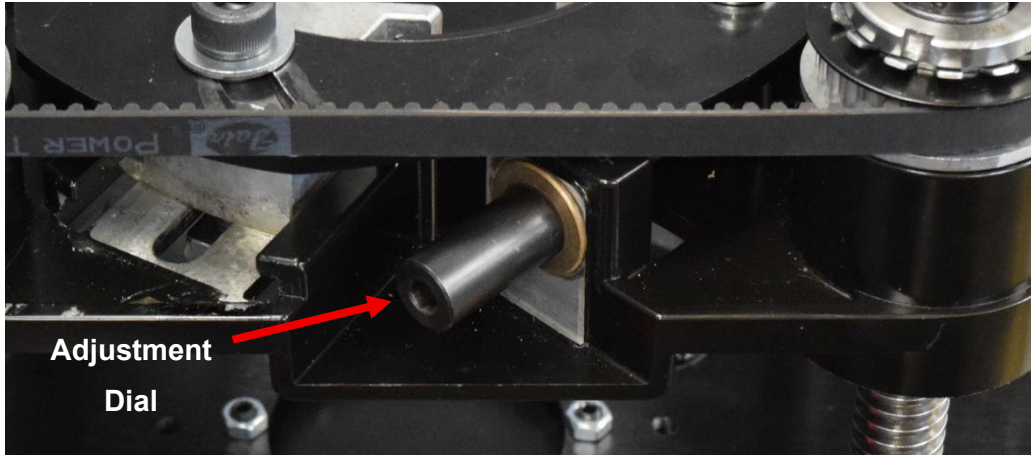

7. Tighten the three clamping bolts on the bottom side of the three clamp positions using the supplied 8mm Allen key.

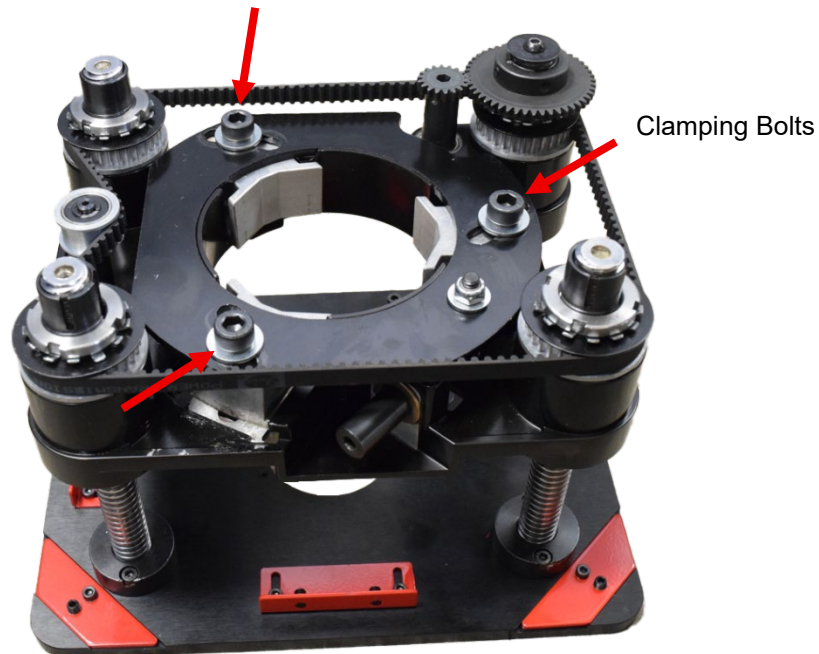

8. Ensure the router is secure in the router lift.

5.5 Installing the Router and Router Lift Table

9. Install the router and router lift assembly back into the table opening with the scale plate wheel oriented toward the operator position.

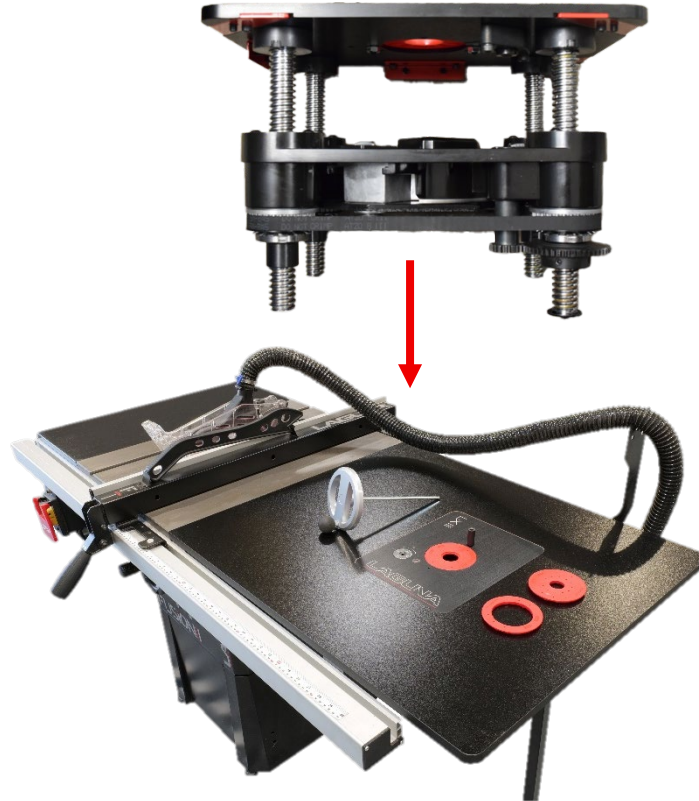

9. Inspect the lift plate to table leveling with the additional weight of the router in the lift. Make any minor adjustments if necessary.
10. Lay a straight edge across the router table top so that it extends over the top of the aluminum router plate. Inspect the router lift and make sure the edges are flush with the table. Check all four edges router plate.
11. Lower and raise the router in the lift using the handwheel to make sure that it travels freely up and down without obstructions. Adjust positioning if needed for obstructions or cord placement.

5.6 Scale Plate

The scale plate is a wheel that raises/lowers the router lift. One full revolution equals 1/16" of a change. Each mark is approximately 1/512" (0.001953125")

To "zero out" the graduations on the scale plate, remove the handwheel and rotate the scale plate until the "0" lines up with the etches line in the router lift plate.



5.7 Starter Pin

The starter pin provides a pivot point or anchor for a workpiece, especially when using bearing-guided bits without a fence. It acts as a stable guide to safely bring a workpiece into contact with the spinning router bit and its bearing, reducing the risk of kickback and preventing the bit from grabbing the stock before it is properly supported by the bearing.

WARNING

Always use a starter pin when doing freehand work without a fence (such as template tracing using a bearing bit). Use the starter pin to begin the cut. Failure to use the starter pin for freehand work can result in dangerous workpiece kickback and/or other serious injuries. Use the starter pin ONLY with bearing guided router bits. Use with other types of bits could result in serious injury.

DANGER

Keep hands and fingers away from spinning router bits. Use push blocks where needed and maintain awareness of the bit at all times.

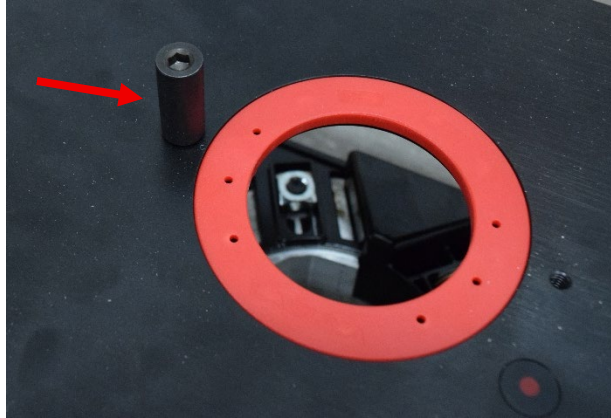

Use of the starter pin and bearing-guided router bit is required for any free-hand cuts without the fence. The workpiece is prone to catching and being kicked back or thrown at the start of the cut before the workpiece contacts the bearing guide on the router bit. Position the pin in one of the two threaded holes in the top plate and securely tighten with a 6mm Allen wrench. The workpiece should contact the starter pin prior to contacting the bit and should then be used as a fulcrum when feeding the workpiece into the bit.

6.0 Replacing the Belt

 **WARNING**

Disconnect the router from power when replacing the belt.

Failure to do this may result in serious personal injury or damage to the router lift.

1. Lower the lift all the way.
2. Examine and remember the way the belt is oriented.
3. Use a 3mm Allen key to loosen the belt tension bolt.

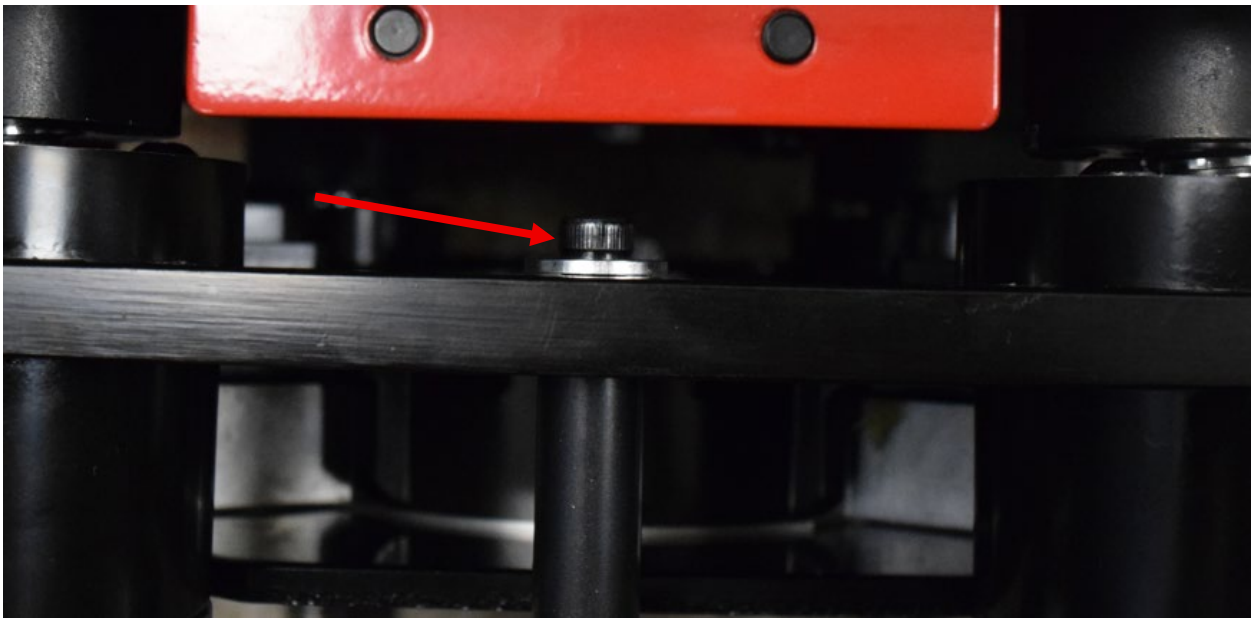

4. Move the tension bolt away from the center of the router lift.
5. Remove the belt and replace with a new belt.
6. Move the tension bolt towards the center of the router lift until the belt is tight.
7. Tighten the tension bolt.

7.0 Maintenance

As with any router lift, to ensure optimal performance you must conduct regular maintenance.

Failure to follow maintenance procedures will void the warranty.

 **WARNING**

Always disconnect power to the router before performing maintenance. Failure to do this may result in serious personal injury or damage to the router lift.

	Daily	Weekly	Monthly	Yearly
Keep the router lift clean. Use towels, vacuum, compressed air, etc.	X			
Inspect all components for damage and repair if necessary.	X			
Annually (or more often if needed due to heavy or frequent use), clean the grease from the 4 Acme threaded lift posts. WD-40 and a brush work well. Reapply a light coat of high-quality multi-purpose grease (such as white lithium) to the threads of the lift posts. Wipe off excess grease. Cycle the lift up and down to evenly distribute the new grease.				X

8.0 Troubleshooting

Symptom	Possible Cause	Correction
Binding Lift	Dirty or clogged threads in lift posts	Clean debris and grease from the 4 Acme threaded lift posts. WD-40 and a brush work well. Reapply a light coat of high-quality multi-purpose grease (such as white lithium) to the threads of the lift posts. Wipe off excess grease. Cycle the lift up and down to evenly distribute the new grease.
	Dirty or clogged gears in lift mechanism	Clean and lubricate gear teeth as described above
	Improper adjustment of router lift	If the timing is off between the 4 posts of the lift mechanism, the gearing for the belt must be adjusted. Loosen the belt by loosening the idler bearing. Check the belt gear at each corner to see if one has more tension than the others by rotating by hand. Mark the edge of one tooth and the position on the adjacent lift frame before rotating the gears. A single gear could be off by a tooth or two if it was rotated independently with the belt off. If one corner is binding, slowly rotate the gear until each has the same tension and then reinstall the belt and tighten. In the worst case, rotate all the gears to move the lift plate up to the top, measure distances between the lift plate and the top plate, adjust as necessary to even out distance on all 4 posts and then reinstall and tighten belt.

LX3 Router Lift Owner's Manual

Wandering or uneven cuts	Loose router	Loosen the 3 clamping bolts from the bottom side of the lift mechanism. Tighten the router clamps using the handwheel or 1/4" Allen wrench to make sure the router is securely tightened in the lift. Retighten the 3 clamping bolts using an 8 mm Allen wrench.
	Lost Bit	Check that the router collet is clean and free of dust. Check the threads on the router collet nut to make sure they are clean. Reinstall the bit and tighten securely.
	Play in lift plate table opening	Adjust and tighten the edge tension plates on the bottom of the top plate to eliminate play between lift top plate and table opening.
Lift does not move when turning the handwheel	Handwheel hex shaft not fully inserted into gearing mechanism	Slowly rotate the handwheel while lowering it down through the scale plate opening and continue until hex shaft engages the gear mechanism on the lift carriage.
Insert rings not flush with lift top plate	Insert ring adjustment not set	Check for debris between the insert ring and the router lift top plate. Clean if needed. If still not level, adjust using the 3 insert plate levelling screws using a 3 mm Allen wrench from the bottom side of the lift top plate.
Router Lift top plate not level with table opening	Lift leveling plates misadjusted	Clean any debris between the router lift and table opening. Level the router lift top plate with the table surface using the 4 leveling plates in the corners of the top plate. Tighten second bolt in levelling plates once adjustment is verified.

9.0 Exploded Parts View and Parts List

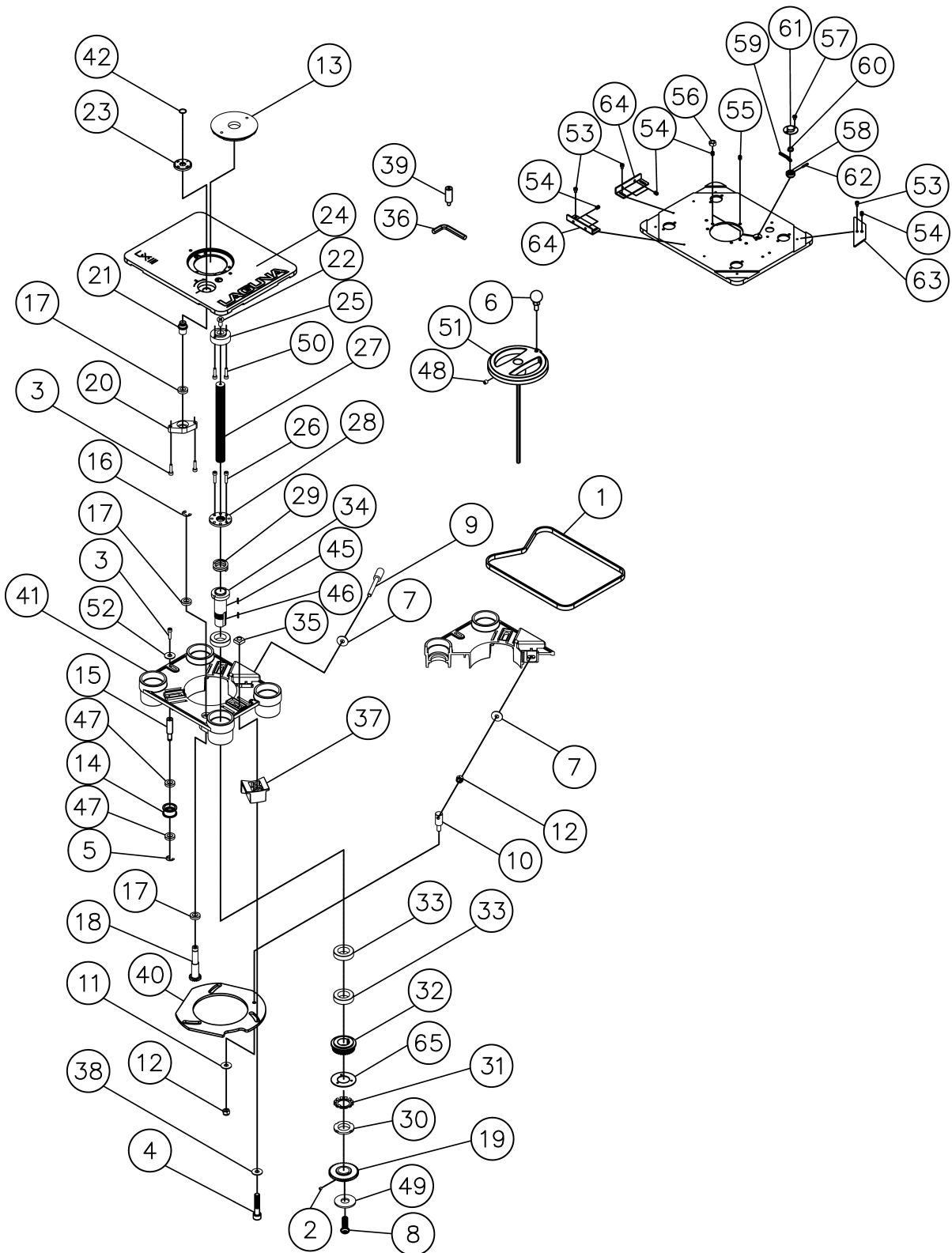

LX3 Router Lift Owner's Manual

Parts List				
Ref. No.	Part Number	Description	Specification	Qty
1	MRL300-101	Timing Belt		1
2	MRL300-102	Set Screw	M5x5	4
3	MRL300-103	Socket Head Cap Screw	M5x20	3
4	MRL300-104	Socket Head Cap Screw	M10x50	3
5	MRL300-105	E-Ring	E6	1
6	PLAREVO1836-181	Knob		1
7	480BS-107	Oilite Washer		2
8	MRL300-108	Socket Head Button Screw	M6x10	1
9	MRL300-109	Adjusting Screw		1
10	MRL300-110	Disc Bolt		1
11	PLAREVO1836-1113	Flat Washer	d8xD18x2t	1
12	MRL300-112	Nylon Inserted Lock Nut	5/16"-18UNC	2
13	MRL300-113A	Table Insert	1"(25mm)	1
	MRL300-113B	Table Insert	1-3/16"(30mm)	1
	MRL300-113C	Table Insert	2-5/8"(66.7mm)	1
14	MRL300-114	Idler		1
15	MRL300-115	Idler Shaft		1
16	MRL300-116	C-Ring	S13	1
17	MRL300-117	Ball Bearing	6802zz	3
18	MRL300-118	Gear		1
19	MRL300-119	Gear		1
20	MRL300-120	Bearing Base		1
21	MRL300-121	Shaft		1
22	MRL300-122	Phillips Flat Head Screw	M6x15	4
23	MRL300-123	Scale Plate		1
24	MRL300-124	Top Plate		1
25	MRL300-125	Screw Base		4
26	MRL300-126	Special Screw		8
27	MRL300-127	Screw		4
28	MRL300-128	Nuts		4
29	MRL300-129	Spring		4
30	MRL300-130	Bearing Nuts		4
31	MRL300-131	Toothed Lock Washers for Bearings		4
32	MRL300-132	Timing Pulley		4
33	MRL300-133	Thrust Bearing	B51105	8
34	MRL300-134	Screw Bushing		4
35	MRL300-135	Square Nuts	M10x1.5	3
36	MRL300-136	Allen Wrench	M8	1
37	MRL300-137	Slide Block		3
38	PLAREVO1836-1112	Flat Washer	d10xD23x2t	3
39	PLAREVO1216-174	Stop Bolt		1
40	MRL300-140	Adjusting Disc		1

LX3 Router Lift Owner's Manual

41	MRL300-141	Base		1
42	PLAREVO1216-1105	O-Ring	P12	1
45	MRL300-145	Key	3x3x10	4
46	MRL300-146	Key	3x3x16	1
47	MRL300-147	Ball Bearing	608RS	2
48	PLAREVO1836-1119	Set Screw	1/4-20UNCX3/8"	2
49	MRL300-149	Flat Washer	d1/4"xD25x1.5t	1
50	PLAREVO1216-155	Socket Head Cap Screw	M5x15	8
51	MRL300-151	Handwheel		1
52	MRL300-152	Flat Washer	d5.2xD16x1.5t	1
53	MRL300-153	Socket Head Cap Screw	M4x6	8
54	MRL300-154	Set Screw	M6x8	10
55	MRL300-155	Set Screw	M6x4	3
56	MRL300-156	Hex Nut	M6x1.0	2
57	MRL300-157	Screw	M4x6	2
58	MRL300-158	Button		1
59	MRL300-159	Rod		1
60	MRL300-160	Spring		1
61	MRL300-161	Cover		1
62	MRL300-162	Pin	Ø3x16	1
63	MRL300-163	Height Adjustment Plate		4
64	MRL300-164	Gap Adjustment Plate		2
65	MRL300-165	Plate		4

10.0 Warranties

Dealer Machine Warranty

New woodworking machines sold by Laguna Tools carry a two-year warranty effective from the date of dealer invoice to customer/end-user. Machines sold through dealers must be registered with Laguna Tools within thirty (30) days of purchase to be covered by this warranty. Laguna Tools guarantees all new machines sold to be free of manufacturers' defective workmanship, parts, and materials. We will repair or replace, without charge, any parts determined by Laguna Tools, Inc. to be a manufacturer's defect. We require that the defective item/part be returned to Laguna Tools with the complaint. The end-user must request a Return Material Authorization (RMA) number from Customer Service. Include the RMA number with any and all returned parts/components requesting warranty coverage*. Any machines returned to Laguna Tools must be returned with packaging in the same manner in which it was received. A part or blade is being returned must have adequate packaging to ensure it is not damaged during shipping. In the event the item/part is determined to be damaged due to lack of maintenance, cleaning, or misuse/abuse, the customer will be responsible for the cost to replace the item/part, plus all related shipping charges. This limited warranty does not apply to natural disasters, acts of terrorism, normal wear and tear, product failure due to lack of maintenance or cleaning, damage caused by accident, neglect, lack of or inadequate dust collection, misuse/abuse or damage caused where repair or alterations have been made or attempted by others.

* The issue of an RMA number is for reference only; it DOES NOT indicate acceptance of the warranty claim.

CNC Limited Warranty

New CNC machines sold by Laguna Tools carry a one-year warranty effective from the date of shipping. Laguna Tools guarantees all new machines sold to be free of manufacturers' defective workmanship, parts, and materials. We will repair or replace, without charge, any parts determined by Laguna Tools, Inc. to be a manufacturer's defect. If the defective item/part is determined to be damaged due to lack of maintenance, cleaning or misuse/abuse, the customer will be responsible for the cost to replace the item/part, plus all related shipping charges. This limited warranty does not apply to natural disasters, acts of terrorism, normal wear and tear, product failure due to lack of maintenance or cleaning, damage caused by accident, neglect, lack of or inadequate dust collection, misuse/abuse or damage caused where repair or alterations have been made or attempted by others.

Laguna Tools, Inc. is not responsible for additional tools or modifications sold or performed (other than from/by Laguna Tools, Inc.) on any Laguna Tools, Inc. woodworking and/or metalworking machine. The

LX3 Router Lift Owner's Manual

warranty may be voided upon the addition of such described tools and/or modifications, determined on a case-by-case basis. Software purchased through Laguna Tools, Inc., is not covered under this warranty and all technical support must be managed through the software provider. Normal user alignment, adjustment, tuning, and machine settings are not covered by this warranty. It is the responsibility of the user to understand basic woodworking machinery settings and procedures and to properly maintain the equipment in accordance with the standards provided by the manufacturer.

Parts under warranty are shipped at Laguna Tools, Inc.'s cost either by common carrier, FEDEX ground service, or a similar method. Technical support to install replacement parts is primarily provided by phone, fax, e-mail or Laguna Tools Customer Support Website. The labor required to install replacement parts is the responsibility of the user. Laguna Tools is not responsible for damage or loss caused by a freight company or other circumstances not in our control. All claims for loss or damaged goods must be notified to Laguna Tools within twenty-four (24) hours of delivery.

Please contact our Customer Service Department for more information. Only NEW machines sold to the original owner are covered by this warranty.

For warranty repair information, call 1-800-332-4094.

Warning: No portion of these materials may be reproduced without written approval from Laguna Tools, Inc.

Copyright© 2025 Laguna Tools, Inc.

No Modifications Allowed or Sold

Laguna Tools, Inc. is not responsible for additional tools or modifications sold or performed (other than from/by Laguna Tools, Inc.) on any Laguna Tools, Inc. woodworking and/or metalworking machine(s). The warranty may be voided upon the addition of such described tools and/or modifications, determined on a case-by-case basis. Normal user alignment, adjustment, tuning, and machine settings are not covered by this warranty. It is the responsibility of the user to understand basic woodworking and/or metalworking machinery settings and procedures and to properly maintain the equipment in accordance with the standards provided by the manufacturer. Parts, under warranty, are shipped at Laguna Tools, Inc.'s cost either by common carrier, FEDEX ground service or a similar method. Technical support to install replacement parts is primarily provided by phone, fax, e-mail, or Laguna Tools Customer Support Website. The labor required to install replacement parts is the responsibility of the user. Laguna Tools is not responsible for damage or loss caused by a freight company or other circumstances not in our control. All claims for loss or damaged goods must be notified to Laguna Tools within twenty-four (24) hours of delivery. Please contact our Customer Service Department for more information. Only new machines sold to the original owner are covered by this warranty.

For warranty repair information call 1-800-332-4094.

LX3 Router Lift Owner's Manual

Laguna Tools Warranty

WARRANTY & REGISTRATION

Thank You!

Welcome to the Laguna Tools® group of discriminating woodworkers. We understand that you have a choice of where to purchase your machines and appreciate the confidence you have in the Laguna Tools® brand.

Through hands-on experience, Laguna Tools® is constantly working hard to make innovative, precision products. Products that inspire you to create works of art are a joy to operate and encourage your best work.

Laguna Tools®
Imagination, Innovation, and Invention at Work

Warranty & Registration

Every product sold is warranted to be free of manufacturer's defective workmanship, parts, and materials. For any questions about this produce, the intended use or what it was designed for, customer service, or replacement parts, please contact our customer service department:

Laguna Tools® Customer Service
744 Refuge Way, Grand Prairie, Texas 75050, USA
1-800-234-1976
www.lagunatools.com/why/customer-service/
8AM. To 5PM PSF. Monday through Friday

For warranty claims or to report damage upon receiving-please reach out to our warranty department:

Laguna Tools® Warranty Service
744 Refuge Way, Grand Prairie, Texas 75050, USA
1-800-234-1976
www.lagunatools.com/policies/warranty
8AM to 5PM PST, Monday through Friday

Registration

To prevent voiding this warranty, all products sold must be registered within thirty (30) days of receiving the product. Registering the product will enable the original purchaser to receive notifications about important product changes, receive customer service, and be able to file a warranty claim against defective workmanship, parts, or materials.



Who is Covered

The applicable warranty covers only the initial purchaser of the product from the date of receiving the product. To file such claims, the original purchaser must present the original receipt as proof of purchase.

What is Covered

The warranty covers any defects in the workmanship of all parts and materials that make up the machine unless otherwise specified. Any part determined by Laguna Tools® to have a defect will be repaired or replaced (and shipped), without charge. The defective item/part must be returned to Laguna Tools® with the complaint and proof of purchase in the original packaging that it was received in. In the event the item/part is determined to be not covered by this warranty, the customer will be responsible for the cost to replace the item/part and all related shipping charges.

Warranty Limitations

This limited warranty does not apply to natural disasters, acts of terrorism, normal wear and tear, product failure due to lack of maintenance or cleaning, damage caused by accident, neglect, or lack-of inadequate dust collection. The warranty may be voided against proof of misuse/abuse, damage caused where repair or alterations have been made or attempted by others, using the product for purposes other than those described as intended use (unless with consent by Laguna Tools®), modification to the product, or use with an accessory that was not designed for the product. It is the responsibility of the user to understand basic woodworking machinery settings and procedures and to properly maintain the equipment in accordance with the standards provided in this manual.

Length of Warranty

All new machines and optional accessories sold through an authorized dealer carry a two-year warranty effective from the date of receiving the product. Machines sold for either commercial or industrial use have a one-year warranty. Wearable parts like throat plates, bandsaw guides, etc., have a ninety-day warranty.

Table A-1 Warranty Lengths

2 Year – New Machines Sold Through an Authorized Dealer
2 Year – Accessories Sold as Machine Options (excluding blades)
1 Year – Machines Sold for Commercial or Industrial Use
1 Year – Blades and Accessories outside or Machine Options
90 Days – Wearable Parts

Aside from being free of defects upon receiving, consumable parts, like cutters and abrasives, are not covered by this warranty unless otherwise stated by Laguna Tools®. These parts are designed to be used at the expense of the operator and are available for replacement or inventory purchase. The determination of a consumable part will be made on a case-by-case basis by Laguna Tools®.

Shipping Damage

Laguna Tools® is not responsible for damage or loss caused by a freight company or other circumstances not in the direct control of Laguna Tools®. All shipping-related claims for loss or damage to goods must be made to Laguna Tools® within twenty-four hours of delivery.

How to Receive Support

To file a warranty claim, please contact the warranty department at 1-800-234-1976. To receive customer service or technical support, please contact the customer service department at 1-800-332-4094. Parts, under warranty, are shipped at the expense of Laguna Tools® either by common carrier, FedEx ground services, or similar method. Technical support to install replacement parts is primarily provided by phone, fax, email, or the Laguna Tools® Customer Service Support Website.



© 01/2025 Laguna Tools, Inc.

LAGUNA

Laguna Tools, Inc.

744 Refuge Way, Suite 200

Grand Prairie, TX 75050

1-800-234-1976

www.lagunatools.com

Copyright © 2025 Laguna Tools, Inc. All rights reserved.